

ER230-2700

ER230-2700,
Maxium payload 230 kg with maxium reach 2702 mm.

- Highlights**
A brand new heavy-duty platform product, with all shafts connected by rigid gears, providing superior torque performance for the robot wrist;
The robot's repeated positioning accuracy has been improved by 50%, which belongs to the leading level in the same level and can cope with various high-precision application scenarios;
Combining high rigidity transmission design with advanced trajectory algorithms, it has stronger dynamic performance and more stable high-speed operation.

- Applications**
It can be used in Spot welding, SW-Stud welding, handling operations, cell changing disc and group disc, palletizing, assembling, grinding, polishing, etc.

- Industries**
Suitable for auto, Lithium battery, photovoltaic, food and beverage, building materials, logistics and warehousing and other industries.



EFORT Intelligent Robot Co., Ltd.
PHONE: (00 86) 400-052-8877
ADDRESS: No. 96, Wanchun East Road, Wuhu, China
(Anhui) Pilot Free Trade Zone
WWW.EFORT.COM.CN

EFORT

SPECIFICATIONS

Model		ER230-2700
Type		Articulated
Controlled axes		6 Axes
Max. payload on wrist		230 kg
Repeatability		±0.05 mm
Robot weight		1320 kg
Reach		2702 mm
Robot IP grade		IP65
Cabinet IP grade		IP54
Drive mode		AC servo drive
Installation		Floor
Installation enviroment	Ambient temperature	0~45 °C
	Ambient humidity	RH≤80% (No dew nor frost allowed)
	Vibration acceleration	4.9 m/s ² (<0.5 G)

Allowable load moment at wrist	J4	1400 N·m
	J5	1400 N·m
	J6	745 N·m
Allowable load inertia at wrist	J4	180 kg·m ²
	J5	180 kg·m ²
	J6	85 kg·m ²
Maximum speed	J1	130°/sec
	J2	110°/sec
	J3	115°/sec
	J4	170°/sec
	J5	120°/sec
	J6	220°/sec
Motion range	J1	±185°
	J2	+65°-85°
	J3	+180°-70°
	J4	±360°
	J5	±130°
	J6	±360°

OPERATING SPACE

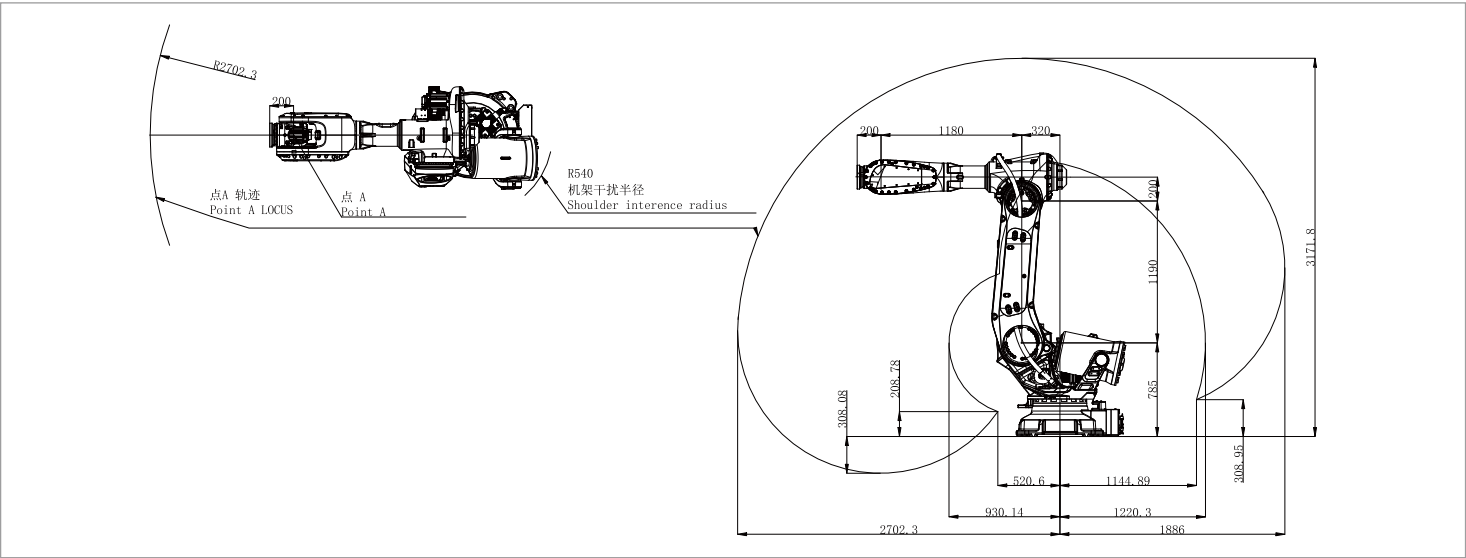

BASE MOUNTING SIZE

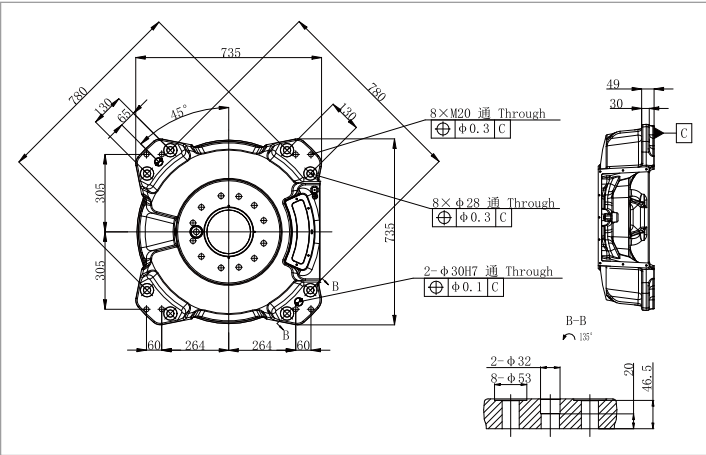

END FLANGE MOUNTING SIZE

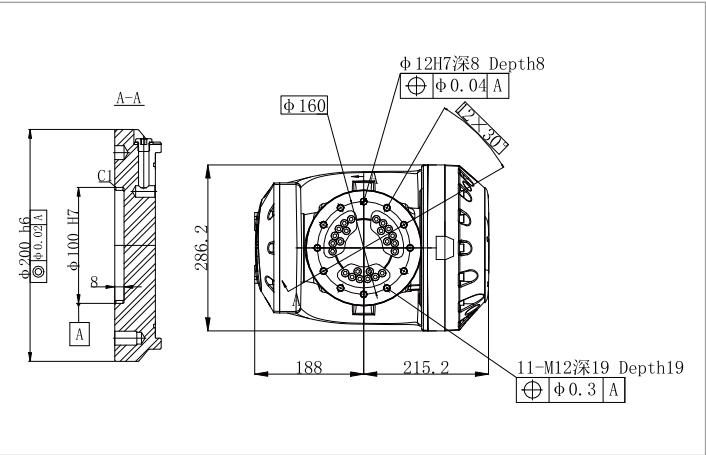

*The final interpretation right belongs to EFORT Intelligent Robot Co., Ltd. Any updates will be made without prior notice.