

# ECR5

**ECR5,**

**Maximum payload 5 kg with maximum reach 928 mm, Repeatability  $\pm 0.03$  mm.**

## ■ Highlights

Multiple safety design in both hardware and software with sensitive collision detection, helps realize fenceless human-machine cooperative operation.

**Note: Safety features are designed according to ISO 13849 PLD, Cat.3 safety criterias;**

The agile and easy-to-use drag teaching function greatly simplifies the programming and manipulation the robot. Thanks to the lightweight structure design, customers can achieve rapid deployment and flexible production management; Thanks to our origin of industrial robots, ECR 5 accuracy grade and operation stability can be comparable to that of industrial robots with the same load.

## ■ Applications

It can be used in handling, sorting, assembling, machine tending, etc.

## ■ Industries

Suitable for 3C, food and beverage, metal parts, education, plastic, pharmaceutical and other industries, can also be used in consumer industries.



**EFORT Intelligent Robot Co., Ltd.**

PHONE: (00 86) 400-052-8877

ADDRESS: No. 96, Wanchun East Road, Wuhu, China

(Anhui) Pilot Free Trade Zone

WWW.EFORT.COM.CN

**EFORT**

## SPECIFICATIONS

Model		ECR5
Type		Articulated
Controlled axes		6 Axes
Max. payload on wrist		5 kg
Repeatability		±0.03 mm
Robot weight		20.5 kg
Reach		928 mm
Robot IP grade		IP54
Cabinet IP grade		IP40
Drive mode		Low-voltage servo drive
Installation		Floor, Upside-down, Wall, Angle
Installation enviroment	Ambient temperature	0~50 °C
	Ambient humidity	RH≤80% (No dew nor frost allowed)
	Vibration acceleration	4.9 m/s <sup>2</sup> (<0.5 G)

Allowable load moment at wrist	J4	19 N·m
	J5	13 N·m
	J6	13 N·m
Allowable load inertia at wrist	J4	0.8 kg·m <sup>2</sup>
	J5	0.4 kg·m <sup>2</sup>
	J6	0.4 kg·m <sup>2</sup>
Maximum speed	J1	150°/sec
	J2	150°/sec
	J3	150°/sec
	J4	180°/sec
	J5	180°/sec
	J6	180°/sec
Motion range	J1	±180°
	J2	±180°
	J3	±160°
	J4	±180°
	J5	±180°
	J6	±360°

## OPERATING SPACE

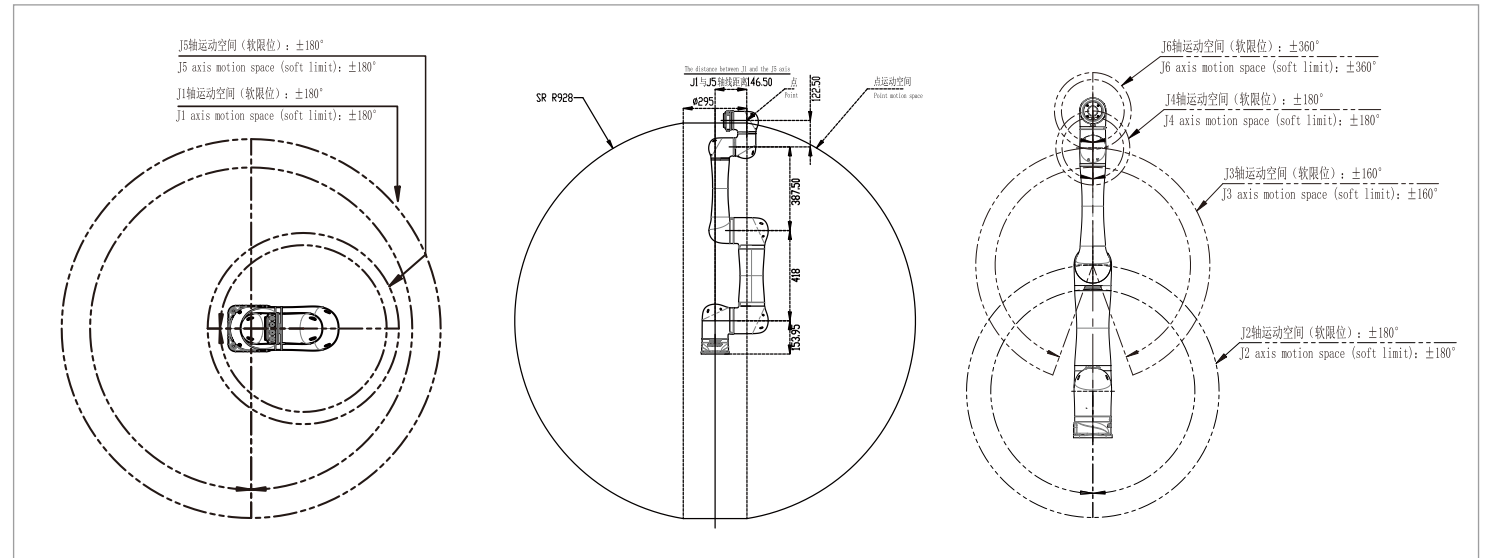

### BASE MOUNTING SIZE

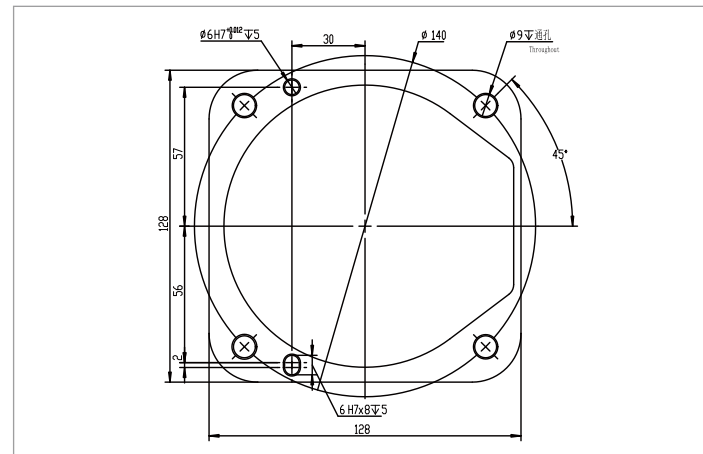

## END FLANGE MOUNTING SIZE

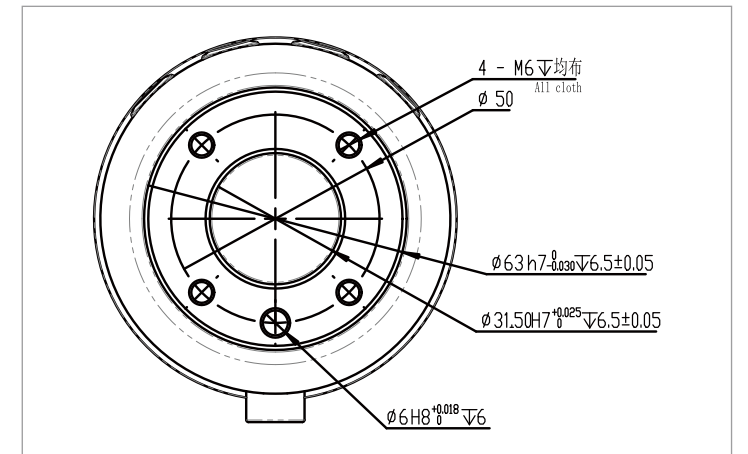

\*The final interpretation right belongs to EFORT Intelligent Robot Co., Ltd. Any updates will be made without prior notice.

Information Release Time 2025/04